

Andrews Square

56 E Andrews Dr, NW, Atlanta, GA



ANDREWS SQUARE SITE PLAN

| NO. | RETAILERS | SF |
|-----|--------------------------|-------|
| 10 | Lilly Pulitzer | 2,000 |
| 30 | Means & Carney Interiors | 1,810 |
| 40 | Skin Laundry | 1,680 |
| 50 | Yebo | 7,410 |
| 60 | Henri's Bakery | 2,000 |
| 70 | Weezie | 1,758 |
| 80 | House of Wallace | 1,650 |
| 95 | Miller Collective | 2,025 |
| 100 | Simply Put Paper & Gifts | 960 |
| 120 | tasc performance | 2,040 |
| 130 | Poppy's of Atlanta | 2,720 |
| 140 | Boxwoods Gardens & Gifts | 2,095 |
| 200 | EDENS | 3,765 |
| 220 | Available | 860 |
| 230 | Pêche Pilates | 1,010 |
| 235 | Available | 2,740 |
| 245 | Cindy Ensor Designs | 1,910 |
| 250 | Skin I.Q. | 1,400 |
| 255 | Slim Studio | 2,645 |
| 258 | Labara Salon | 1,000 |
| 260 | Les Mains | 1,710 |
| 265 | Lucy's Market | 6,444 |
| 270 | Lucy's Baskets | 2,250 |
| 300 | Available | 2,408 |
| 400 | Labels Resale Boutique | 3,454 |
| 887 | Krewe Tiny House Pop-up | - |

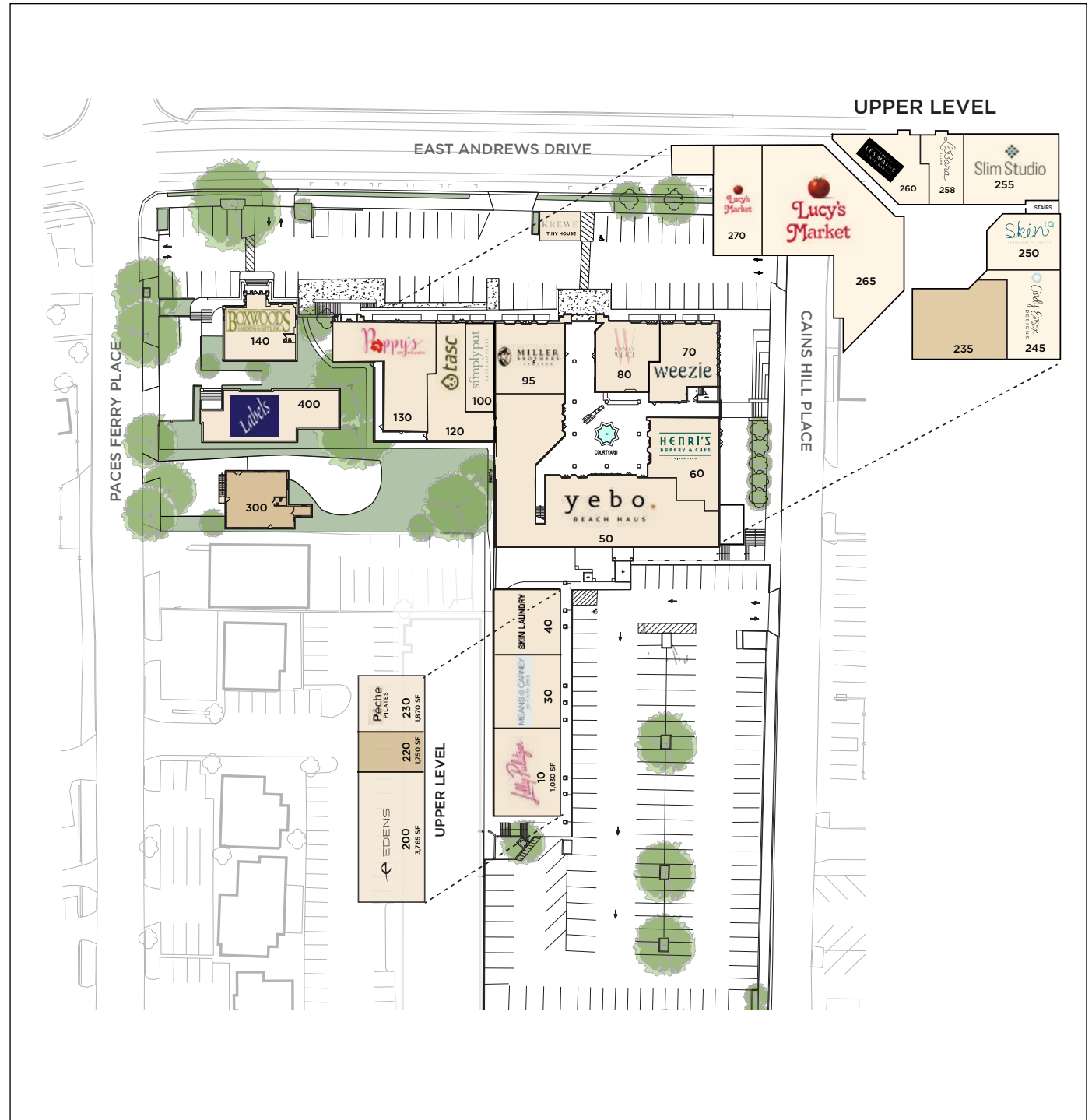

ANDREWS
SQUARE
CENTER
PHOTOS



CENTER
HIGHLIGHTS

Located in the eclectic West Village of Buckhead among Atlanta's best local retail.

Center underwent a redevelopment with new facades, a renovated courtyard and gathering places for dining.

A curated blend of national retailers and unique boutiques, chef-driven restaurants, emerging names and local freinds who've always been a part of the neighborhood.

Daytime office population of more than **340,000** employees supporting over **15.1 million** square feet of office space.



ANDREWS SQUARE TRADE AREA

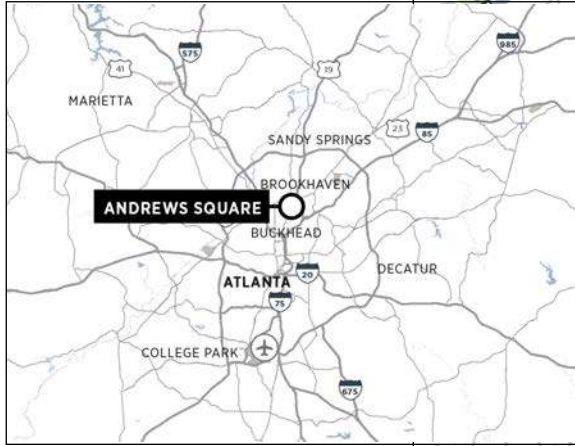

| DEMOGRAPHICS | 1 MILE | 3 MILE | 5 MILE |
|-----------------|-----------|-----------|-----------|
| Population | 20,711 | 127,867 | 337,754 |
| Households | 12,732 | 66,703 | 167,091 |
| Daytime Pop. | 52,987 | 200,403 | 579,265 |
| Avg. HH Income | \$164,815 | \$179,045 | \$166,924 |
| Education Attn. | 76.62% | 80.08% | 78.20% |